

THIS IS A CAD DRAWING - DO NOT MAKE MANUAL CHANGES TO IT.
 PROPERTY OF CMI - DO NOT COPY OR DISTRIBUTE WITHOUT PERMISSION.

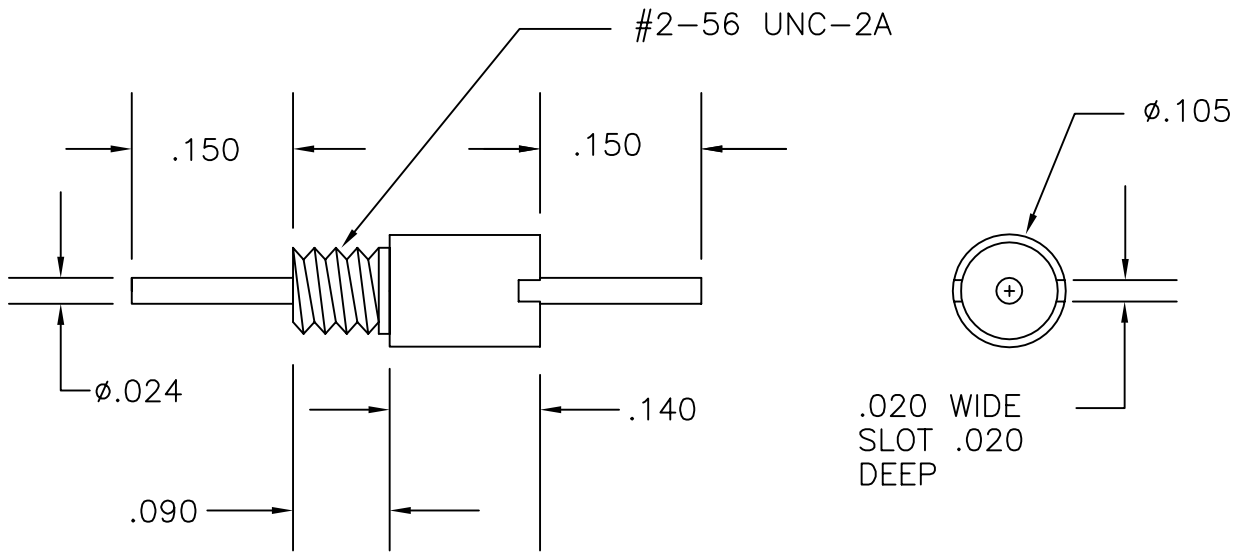

CMI Part Number	Cap (PF)	Tolerance	Voltage	Current
FT26-01-000	10	MAX	100vdc	5A
FT26-01-101P	100	+100/-0%	100vdc	5A
FT26-01-501P	500	+100/-0%	100vdc	5A
FT26-01-102P	1000	+100/-0%	100vdc	5A
FT26-01-302P	3000	+100/-0%	50vdc	5A
FT26-01-502P	5000	+100/-0%	50vdc	5A

Notes:

- LEADS: COPPER ALLOY, GOLD PLATED.
- BUSHING: CRS, GOLD PLATED.
- MOUNTING TORQUE: 14 IN-OZ MIN, 18 IN-OZ MAX.
- RECOMMENDED SOLDER CONNECTIONS: 230° FOR 5-7 SECONDS.
- OPERATING TEMPERATURE RANGE: -55°C TO +125°C.
- SPANNER MOUNTING TOOL P/N FT26-01-999 SHOWN BELOW:

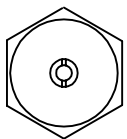

DATE	C.O.	REV	A	B	0	1
9/18/02	-	-				
3/19/03						
6/05/03						
7/02/03						

UNLESS OTHERWISE NOTED
 ALL DIMENSIONS ARE IN INCHES

GENERAL TOLERANCES
 UNLESS OTHERWISE SPECIFIED

DECIMAL: ± .005
 ANGLES: ± 1°

CAGE CODE
 15717

One Plastics Rd - Corry, PA 16407
 (814) 664-7728 FAX (814) 664-4582
www.CORMIC.com

Dwg By: RPS	Date: 9/18/02	Chk'd By:
Scale: NONE		
#2-56 SPANNER FEEDTHROUGH		
FT26-01-XXXX		