

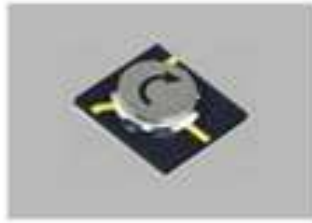

CORRY MICRONICS, INC

# PRODUCT SPECIFICATION

## Dual Microstrip Isolators and Circulators



### Features :

- ◇ Small size, Low Height, Light weight
- ◇ Micro circuit and load resistance integrated in one chip for high stability and reduced size.
- ◇ Frequencies from 2.7GHz-40GHz with relative bandwidth 30% max.
- ◇ Microstrip dual module maximum forward power of up to 150W, reverse power of up to 30~40W.
- ◇ All Dimensions are in inches[mm]

### Application :

- ◇ Widely used in military applications and communications equipment.

### Installation Process :

- ◇ Microstrip dual modules can be attached to PCB in 3 ways:
  - Soldering
  - Wire bonding
  - Other methods according to user's process assembly requirements

**CALL OUR SALES DEPARTMENT FOR MORE INFORMATION OR VARIATIONS OF THIS PRODUCT.**

**Corry Micronics, Inc.    One Plastics Rd. - Corry, PA 16407**  
**(724) 940-7556 ext. 138    Fax (724) 940-7707    [www.cormic.com](http://www.cormic.com)**

Corry Micronics Inc. herein referred to CMI, believes this information to be accurate, but makes no warranties, expressed or implied as to the accuracy of this document. CMI assumes no liability for any injury, loss, damage, direct or consequential arising from the use of our products. User assumes all risk whatsoever in connection with its intended use. CMI also reserves the right to change this document without notice. 05/30/2018



CORRY MICRONICS, INC

# PRODUCT SPECIFICATION

## 5.0-6.0GHz Microstrip Circulator Isolator Module

MODEL	FREQ (GHz)	BAND WIDTH	INSERTION LOSS (dB)		ISOLATION (dB)				VSWR	POWER (W) For. /Rev	OPERATING TEMP RANGE (°C)	WEIGHT (g)
			2-1	1-3	1-2	2-3	3-1	3-2				
CMIDM5055A	5.0-5.5	FULL	0.5	0.9	20	20	30	20	1.25	20/3	-55-+85	4.0
CMIDM5258A	5.2-5.8	FULL	0.6	1.0	20	20	30	20	1.25	20/3	-55-+85	4.0
CMIDM5359A	5.3-5.9	FULL	0.6	1.0	20	20	30	20	1.25	20/3	-55-+85	4.0

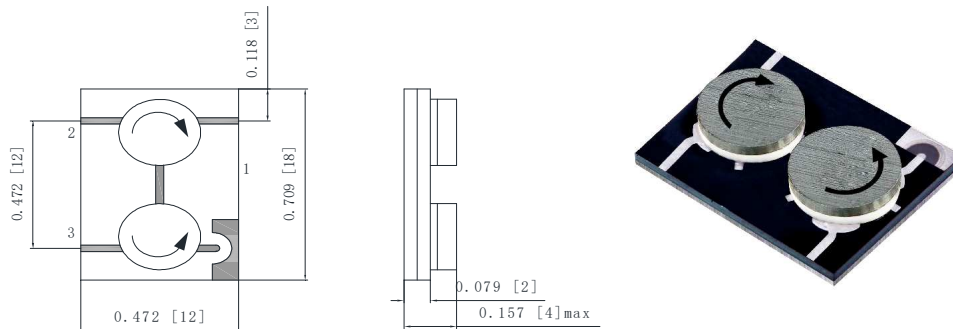
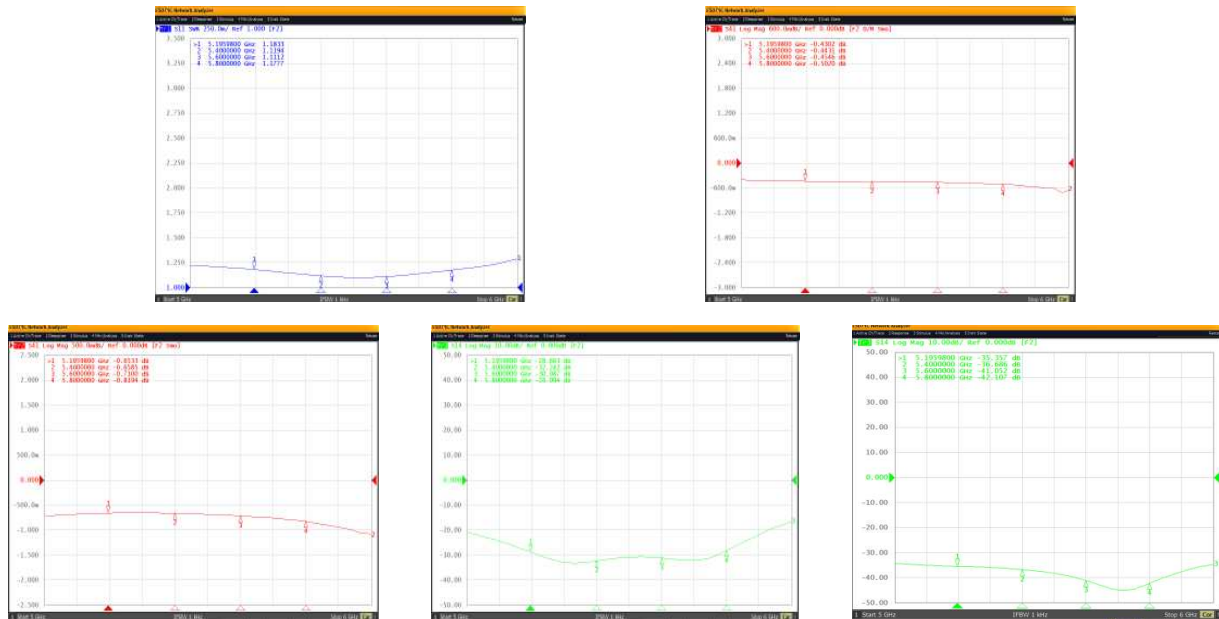

Figure 3-1-1



**CALL OUR SALES DEPARTMENT FOR MORE INFORMATION OR VARIATIONS OF THIS PRODUCT.**

**Corry Micronics, Inc. One Plastics Rd. - Corry, PA 16407**  
**(724) 940-7556 ext. 138 Fax (724) 940-7707 [www.cormic.com](http://www.cormic.com)**

Corry Micronics Inc. herein referred to as CMI, believes this information to be accurate, but makes no warranties, expressed or implied as to the accuracy of this document. CMI assumes no liability for any injury, loss, damage, direct or consequential arising from the use of our products. User assumes all risk whatsoever in connection with its intended use. CMI also reserves the right to change this document without notice. 05/30/2018



CORRY MICRONICS, INC

# PRODUCT SPECIFICATION

## 8.0-12.0GHz Microstrip Circulator Isolator Module

MODEL	FREQ (GHz)	BAND WIDTH	INSERTION LOSS (dB)		ISOLATION (dB)				VSWR	POWER (W) For. /Rev	OPERATING TEMP RANGE (°C)	WEIGHT (g)
			2-1	1-3	1-2	2-3	3-1	3-2				
CMIDM8393A	8.3-9.3	FULL	0.5	0.9	20	20	30	20	1.25	15/3	-55-+85	2.0
CMIDM9096A	9.0-9.6	FULL	0.5	0.9	20	20	30	20	1.25	15/3	-55-+85	2.0
CMIDM95105A	9.5-10.5	FULL	0.5	0.9	20	20	30	20	1.25	15/3	-55-+85	2.0
CMIDM100110A	10.0-11.0	FULL	0.5	0.9	20	20	30	20	1.25	15/3	-55-+85	2.0
CMIDM110120A	11.0-12.0	FULL	0.5	0.9	20	20	30	20	1.25	15/3	-55-+85	2.0
CMIDM80120A	8.0-12.0	FULL	0.7	1.2	14	14	26	14	1.35	15/3	-55-+85	2.0

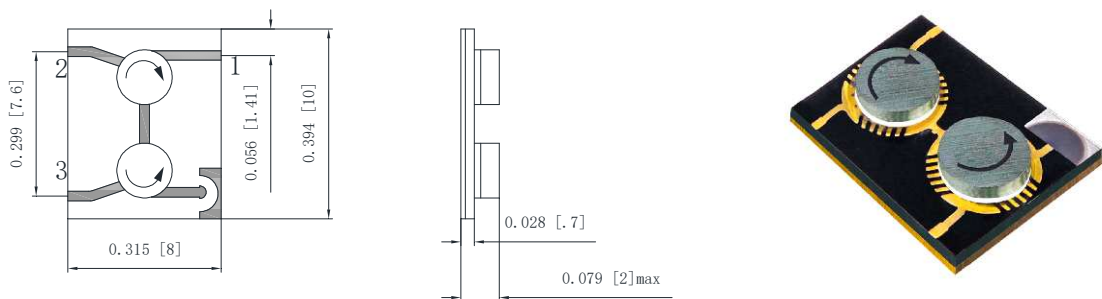
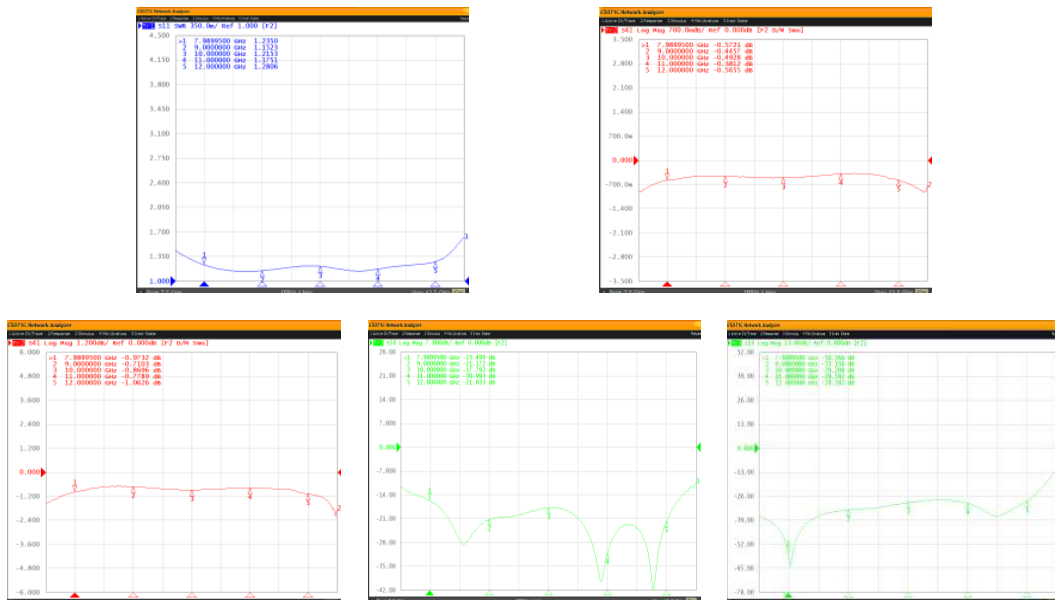

Figure 3-1-2



**CALL OUR SALES DEPARTMENT FOR MORE INFORMATION OR VARIATIONS OF THIS PRODUCT.**

**Corry Micronics, Inc.** One Plastics Rd. - Corry, PA 16407  
(724) 940-7556 ext. 138 Fax (724) 940-7707 [www.cormic.com](http://www.cormic.com)

Corry Micronics Inc. herein referred to as CMI, believes this information to be accurate, but makes no warranties, expressed or implied as to the accuracy of this document. CMI assumes no liability for any injury, loss, damage, direct or consequential arising from the use of our products. User assumes all risk whatsoever in connection with its intended use. CMI also reserves the right to change this document without notice. 05/30/2018



CORRY MICRONICS, INC

# PRODUCT SPECIFICATION

## 14.0-18.0GHz Microstrip Circulator Isolator Module

MODEL	FREQ (GHz)	BAND WIDTH	INSERTION LOSS (dB)		ISOLATION (dB)				VSWR	POWER (W) For. /Rev	OPERATING TEMP RANGE (°C)	WEIGHT (g)
			2-1	1-3	1-2	2-3	3-1	3-2				
CMIDM140150A	14.0-15.0	FULL	0.5	0.9	20	20	30	20	1.25	15/3	-55-+85	1.0
CMIDM150160A	15.0-16.0	FULL	0.5	0.9	20	20	30	20	1.25	15/3	-55-+85	1.0
CMIDM155165A	15.5-16.5	FULL	0.5	0.9	20	20	30	20	1.25	15/3	-55-+85	1.0
CMIDM165175A	16.5-17.5	FULL	0.5	0.9	20	20	30	20	1.25	15/3	-55-+85	1.0
CMIDM150180A	15.0-18.0	FULL	0.6	1.0	18	18	30	18	1.30	15/3	-55-+85	1.0
CMIDM140180A	14.0-18.0	FULL	0.7	1.1	16	16	28	16	1.35	15/3	-55-+85	1.0

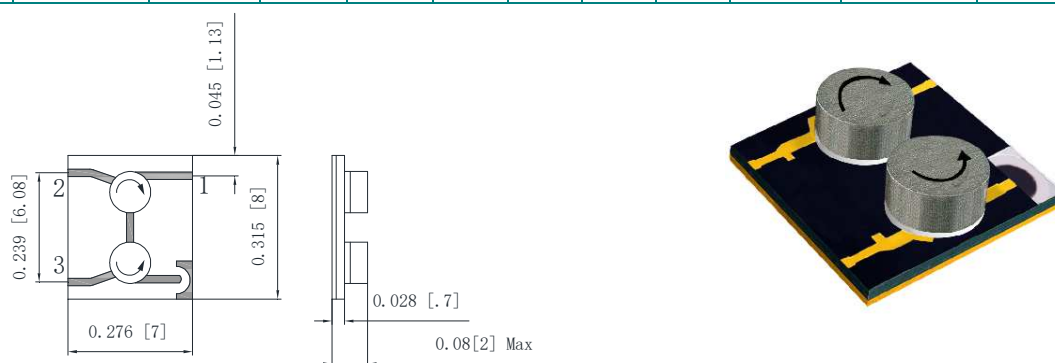
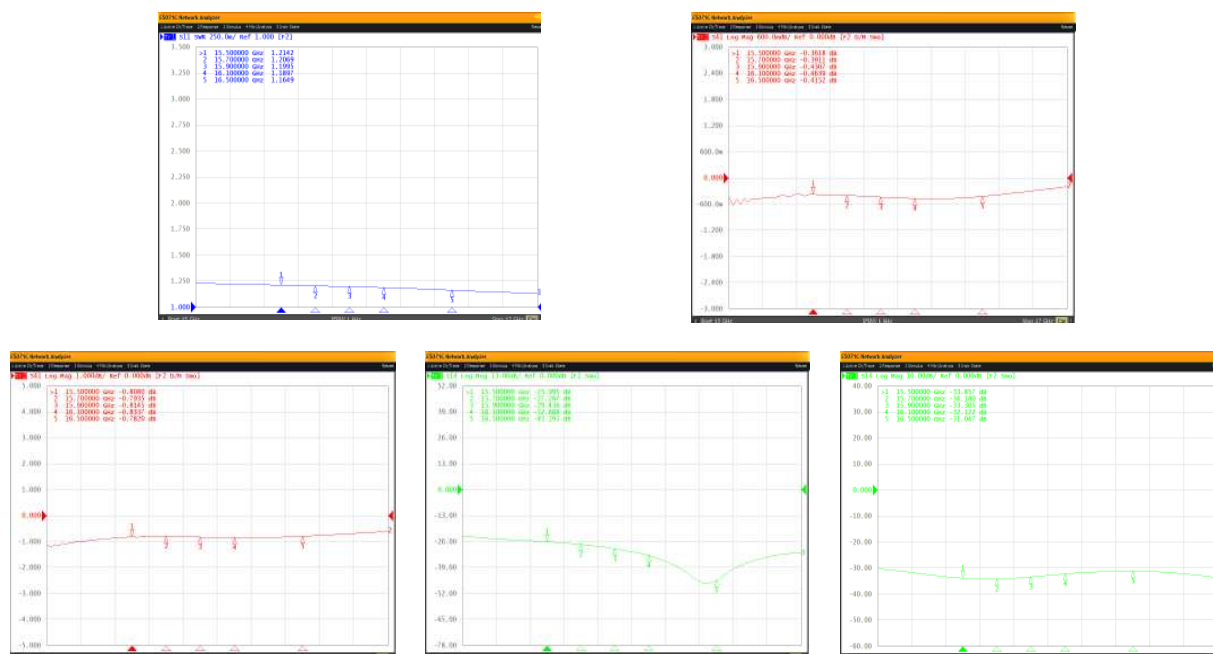

Figure 3-1-3



**CALL OUR SALES DEPARTMENT FOR MORE INFORMATION OR VARIATIONS OF THIS PRODUCT.**

**Corry Micronics, Inc. One Plastics Rd. - Corry, PA 16407**  
**(724) 940-7556 ext. 138 Fax (724) 940-7707 [www.cormic.com](http://www.cormic.com)**

Corry Micronics Inc. herein referred to CMI, believes this information to be accurate, but makes no warranties, expressed or implied as to the accuracy of this document. CMI assumes no liability for any injury, loss, damage, direct or consequential arising from the use of our products. User assumes all risk whatsoever in connection with its intended use. CMI also reserves the right to change this document without notice. 05/30/2018



CORRY MICRONICS, INC

# PRODUCT SPECIFICATION

## 14.0-18.0GHz Microstrip Circulator Isolator Module

MODEL	FREQ (GHz)	BAND WIDTH	INSERTION LOSS (dB)		ISOLATION (dB)				VSWR	POWER (W) For. /Rev	OPERATING TEMP RANGE (°C)	WEIGHT (g)
			2-1	1-3	1-2	2-3	3-1	3-2				
CMIDM140150B	14.0-15.0	FULL	0.5	0.9	20	20	30	20	1.25	15/3	-55-+85	1.0
CMIDM150160B	15.0-16.0	FULL	0.5	0.9	20	20	30	20	1.25	15/3	-55-+85	1.0
CMIDM155165B	15.5-16.5	FULL	0.5	0.9	20	20	30	20	1.25	15/3	-55-+85	1.0
CMIDM165175B	16.5-17.5	FULL	0.5	0.9	20	20	30	20	1.25	15/3	-55-+85	1.0
CMIDM150180B	15.0-18.0	FULL	0.6	1.0	18	18	30	18	1.30	15/3	-55-+85	1.0
CMIDM140180B	14.0-18.0	FULL	0.7	1.1	16	16	28	16	1.35	15/3	-55-+85	1.0

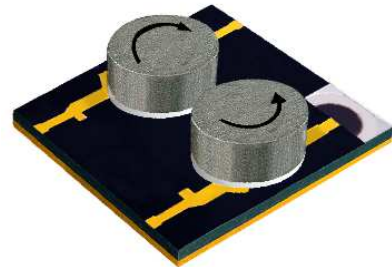
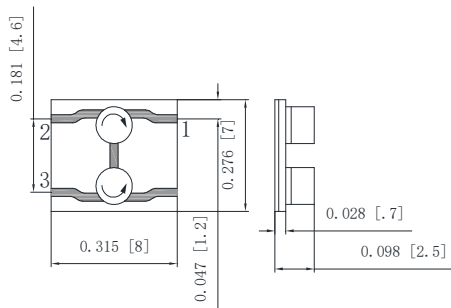

Figure 3-1-4



**CALL OUR SALES DEPARTMENT FOR MORE INFORMATION OR VARIATIONS OF THIS PRODUCT.**

**Corry Micronics, Inc. One Plastics Rd. - Corry, PA 16407**  
**(724) 940-7556 ext. 138 Fax (724) 940-7707 [www.cormic.com](http://www.cormic.com)**

Corry Micronics Inc. herein referred to CMI, believes this information to be accurate, but makes no warranties, expressed or implied as to the accuracy of this document. CMI assumes no liability for any injury, loss, damage, direct or consequential arising from the use of our products. User assumes all risk whatsoever in connection with its intended use. CMI also reserves the right to change this document without notice. 05/30/2018



CORRY MICRONICS, INC

# PRODUCT SPECIFICATION

## 5.0-6.0GHz Microstrip Circulator Isolator Module

MODEL	FREQ (GHz)	BAND WIDTH	INSERTION LOSS (dB)		ISOLATION (dB)				VSWR	POWER (W) For. /Rev	OPERATING TEMP RANGE (°C)	WEIGHT (g)
			2-1	1-3	1-2	2-3	3-1	3-2				
CMIDM5055B	5.0-5.5	FULL	0.5	0.9	20	20	30	20	1.25	20/3	-55-+85	4.0
CMIDM5258B	5.2-5.8	FULL	0.6	1.0	20	20	30	20	1.25	20/3	-55-+85	4.0
CMIDM5359B	5.3-5.9	FULL	0.6	1.0	20	20	30	20	1.25	20/3	-55-+85	4.0

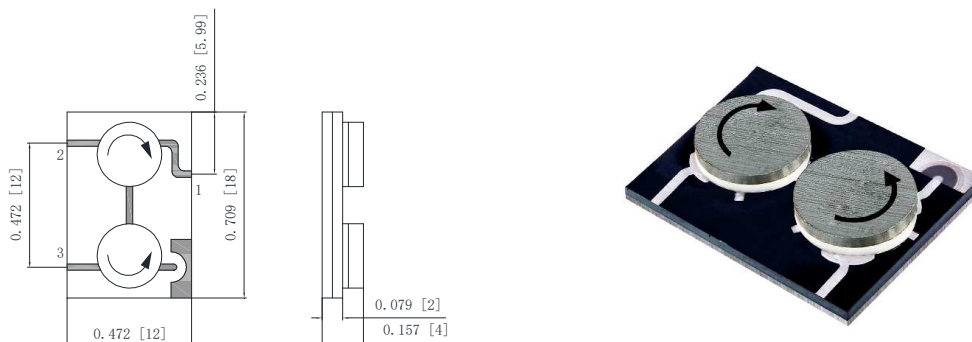
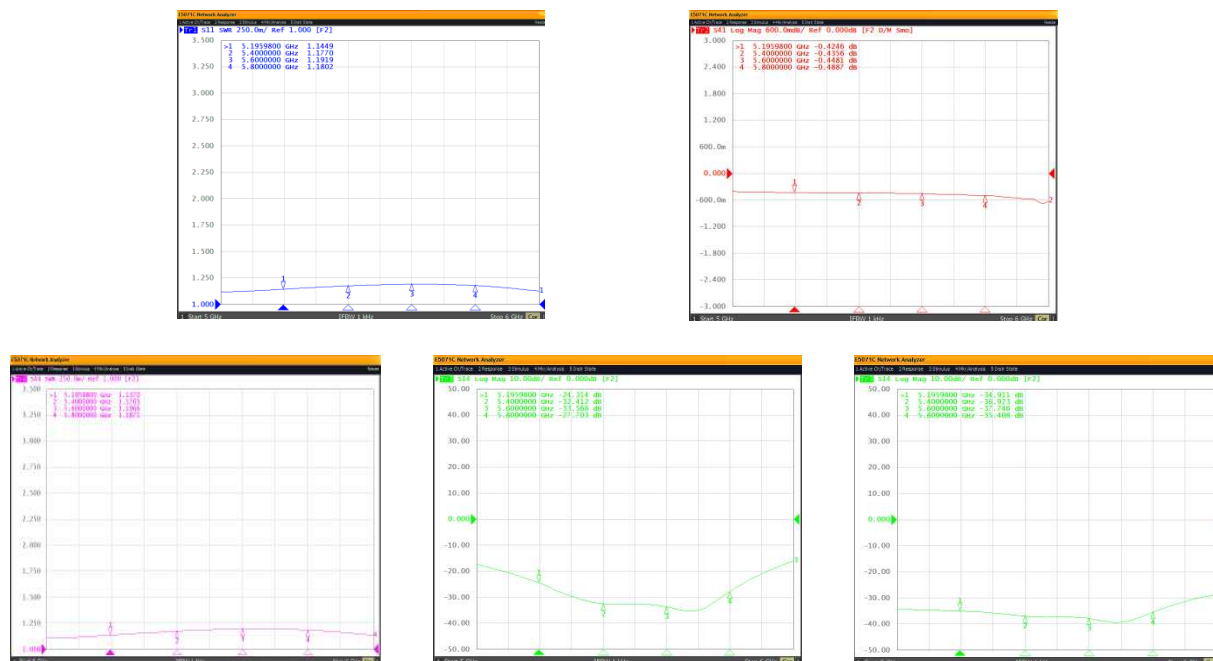

Figure 3-2-1



**CALL OUR SALES DEPARTMENT FOR MORE INFORMATION OR VARIATIONS OF THIS PRODUCT.**

**Corry Micronics, Inc. One Plastics Rd. - Corry, PA 16407**  
**(724) 940-7556 ext. 138 Fax (724) 940-7707 [www.cormic.com](http://www.cormic.com)**

Corry Micronics Inc. herein referred to CMI, believes this information to be accurate, but makes no warranties, expressed or implied as to the accuracy of this document. CMI assumes no liability for any injury, loss, damage, direct or consequential arising from the use of our products. User assumes all risk whatsoever in connection with its intended use. CMI also reserves the right to change this document without notice. 05/30/2018



CORRY MICRONICS, INC

# PRODUCT SPECIFICATION

## 8.0-12.0GHz Microstrip Circulator Isolator Module

MODEL	FREQ (GHz)	BAND WIDTH	INSERTION LOSS (dB)		ISOLATION (dB)				VSWR	POWER (W) For. /Rev	OPERATING TEMP RANGE (°C)	WEIGHT (g)
			2-1	1-3	1-2	2-3	3-1	3-2				
CMIDM8393B	8.3-9.3	FULL	0.5	0.9	20	20	30	20	1.25	15/3	-55-+85	2.0
CMIDM9096B	9.0-9.6	FULL	0.5	0.9	20	20	30	20	1.25	15/3	-55-+85	2.0
CMIDM95105B	9.5-10.5	FULL	0.5	0.9	20	20	30	20	1.25	15/3	-55-+85	2.0
CMIDM100110B	10.0-11.0	FULL	0.5	0.9	20	20	30	20	1.25	15/3	-55-+85	2.0
CMIDM110120B	11.0-12.0	FULL	0.5	0.9	20	20	30	20	1.25	15/3	-55-+85	2.0
CMIDM80120B	8.0-12.0	FULL	0.7	1.2	14	14	26	14	1.35	15/3	-55-+85	2.0



Figure 3-2-2



**CALL OUR SALES DEPARTMENT FOR MORE INFORMATION OR VARIATIONS OF THIS PRODUCT.**

**Corry Micronics, Inc. One Plastics Rd. - Corry, PA 16407**  
**(724) 940-7556 ext. 138 Fax (724) 940-7707 [www.cormic.com](http://www.cormic.com)**

Corry Micronics Inc. herein referred to CMI, believes this information to be accurate, but makes no warranties, expressed or implied as to the accuracy of this document. CMI assumes no liability for any injury, loss, damage, direct or consequential arising from the use of our products. User assumes all risk whatsoever in connection with its intended use. CMI also reserves the right to change this document without notice. 05/30/2018





CORRY MICRONICS, INC

# PRODUCT SPECIFICATION

## 14.0-18.0GHz Microstrip Circulator Isolator Module

MODEL	FREQ (GHz)	BAND WIDTH	INSERTION LOSS (dB)		ISOLATION (dB)				VSWR	POWER (W) For. /Rev	OPERATING TEMP RANGE (°C)	WEIGHT (g)
			2-1	1-3	1-2	2-3	3-1	3-2				
CMIDM140150C	14.0-15.0	FULL	0.5	0.9	20	20	30	20	1.25	15/3	-55-+85	1.0
CMIDM150160C	15.0-16.0	FULL	0.5	0.9	20	20	30	20	1.25	15/3	-55-+85	1.0
CMIDM155165C	15.5-16.5	FULL	0.5	0.9	20	20	30	20	1.25	15/3	-55-+85	1.0
CMIDM165175C	16.5-17.5	FULL	0.5	0.9	20	20	30	20	1.25	15/3	-55-+85	1.0
CMIDM150180C	15.0-18.0	FULL	0.6	1.0	18	18	30	18	1.30	15/3	-55-+85	1.0
CMIDM140180C	14.0-18.0	FULL	0.7	1.1	16	16	28	16	1.35	15/3	-55-+85	1.0

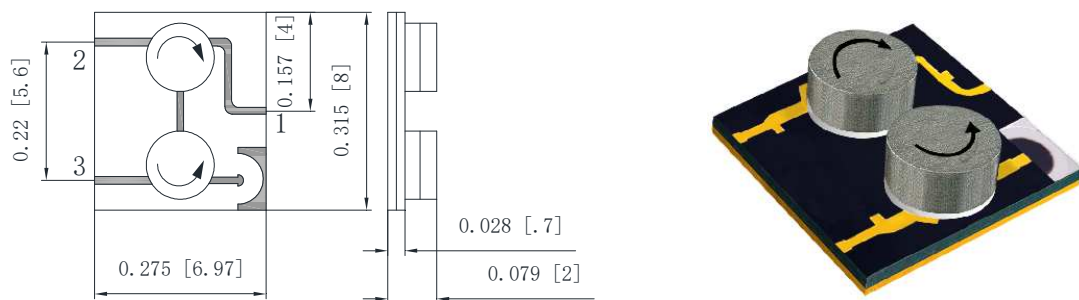
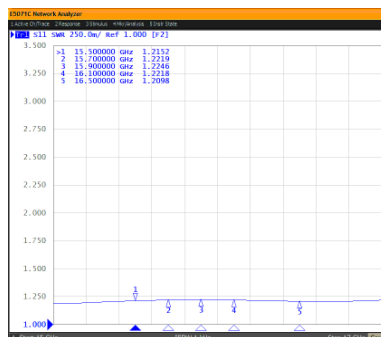

Figure 3-2-3



**CALL OUR SALES DEPARTMENT FOR MORE INFORMATION OR VARIATIONS OF THIS PRODUCT.**

**Corry Micronics, Inc.** One Plastics Rd. - Corry, PA 16407  
**(724) 940-7556 ext. 138** Fax **(724) 940-7707** [www.cormic.com](http://www.cormic.com)

Corry Micronics Inc. herein referred to CMI, believes this information to be accurate, but makes no warranties, expressed or implied as to the accuracy of this document. CMI assumes no liability for any injury, loss, damage, direct or consequential arising from the use of our products. User assumes all risk whatsoever in connection with its intended use. CMI also reserves the right to change this document without notice. 05/30/2018





CORRY MICRONICS, INC

# PRODUCT SPECIFICATION

## 14.0-18.0GHz Microstrip Circulator Isolator Module

MODEL	FREQ (GHz)	BAND WIDTH	INSERTION LOSS (dB)		ISOLATION (dB)				VSWR	POWER (W) For. /Rev	OPERATING TEMP RANGE (°C)	WEIGHT (g)
			2-1	1-3	1-2	2-3	3-1	3-2				
CMIDM140150D	14.0-15.0	FULL	0.5	0.9	20	20	30	20	1.25	15/3	-55-+85	1.0
CMIDM150160D	15.0-16.0	FULL	0.5	0.9	20	20	30	20	1.25	15/3	-55-+85	1.0
CMIDM155165D	15.5-16.5	FULL	0.5	0.9	20	20	30	20	1.25	15/3	-55-+85	1.0
CMIDM165175D	16.5-17.5	FULL	0.5	0.9	20	20	30	20	1.25	15/3	-55-+85	1.0
CMIDM150180D	15.0-18.0	FULL	0.6	1.0	18	18	30	18	1.30	15/3	-55-+85	1.0
CMIDM140180D	14.0-18.0	FULL	0.7	1.1	16	16	28	16	1.35	15/3	-55-+85	1.0

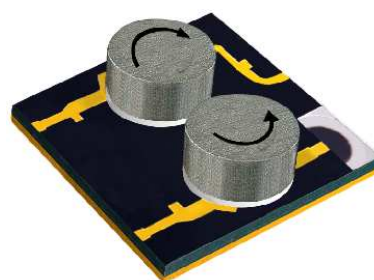
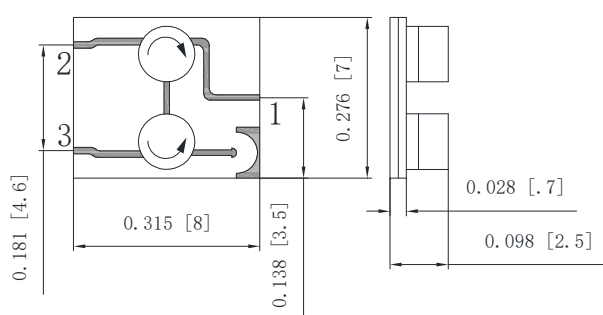

Figure 3-2-4



**CALL OUR SALES DEPARTMENT FOR MORE INFORMATION OR VARIATIONS OF THIS PRODUCT.**

**Corry Micronics, Inc.** One Plastics Rd. - Corry, PA 16407  
**(724) 940-7556 ext. 138** Fax **(724) 940-7707** [www.cormic.com](http://www.cormic.com)

Corry Micronics Inc. herein referred to CMI, believes this information to be accurate, but makes no warranties, expressed or implied as to the accuracy of this document. CMI assumes no liability for any injury, loss, damage, direct or consequential arising from the use of our products. User assumes all risk whatsoever in connection with its intended use. CMI also reserves the right to change this document without notice. 05/30/2018



CORRY MICRONICS, INC

# PRODUCT SPECIFICATION

## 8.0-12.0GHz Magnetically Shielded Microstrip Circulator Isolator Module

MODEL	FREQ (GHz)	BAND WIDTH	INSERTION LOSS (dB)		ISOLATION (dB)				VSWR	POWER (W) For. /Rev	OPERATING TEMP RANGE (°C)	WEIGHT (g)
			2-1	1-3	1-2	2-3	3-1	3-2				
CMISM8393A	8.3-9.3	FULL	0.5	0.9	20	20	30	20	1.25	15/3	-55-+85	1.0
CMISM9096A	9.0-9.6	FULL	0.5	0.9	20	20	30	20	1.25	15/3	-55-+85	1.0
CMISM95105A	9.5-10.5	FULL	0.5	0.9	20	20	30	20	1.25	15/3	-55-+85	1.0
CMISM100110A	10.0-11.0	FULL	0.5	0.9	20	20	30	20	1.25	15/3	-55-+85	1.0
CMISM110120A	11.0-12.0	FULL	0.5	0.9	20	20	30	20	1.25	15/3	-55-+85	1.0
CMISM80120A	8.0-12.0	FULL	0.7	1.2	14	14	26	14	1.35	15/3	-55-+85	1.0



Figure 4-1-1

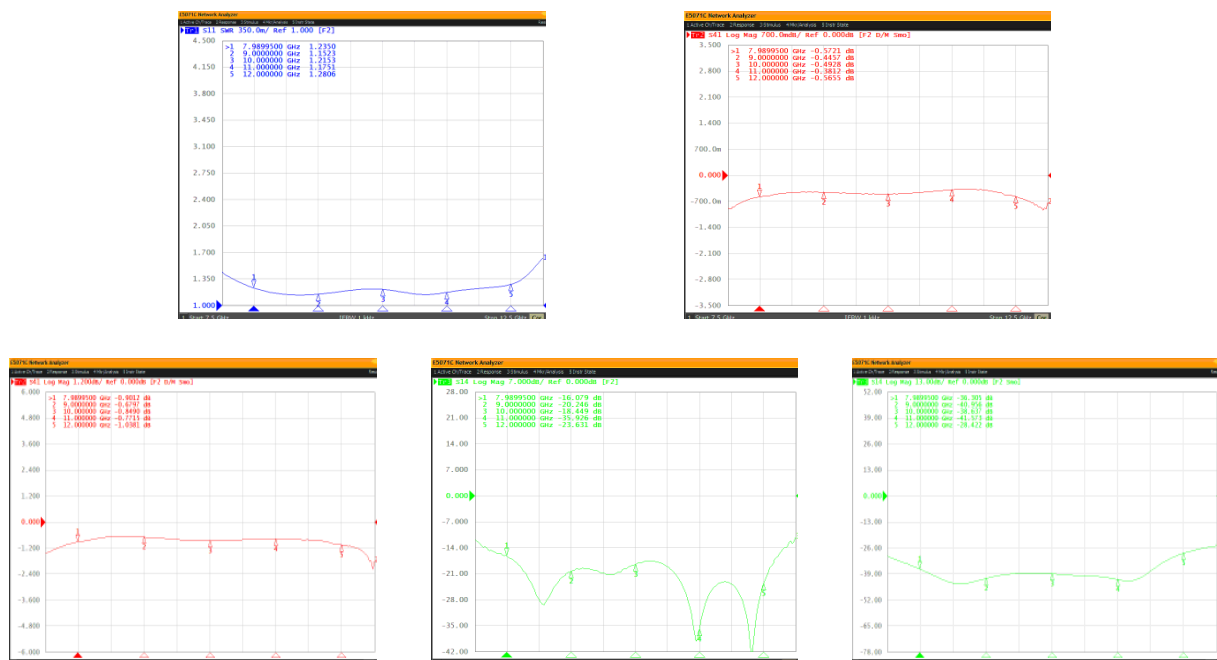

**CALL OUR SALES DEPARTMENT FOR MORE INFORMATION OR VARIATIONS OF THIS PRODUCT.**

**Corry Micronics, Inc. One Plastics Rd. - Corry, PA 16407**  
**(724) 940-7556 ext. 138 Fax (724) 940-7707 [www.cormic.com](http://www.cormic.com)**

Corry Micronics Inc. herein referred to CMI, believes this information to be accurate, but makes no warranties, expressed or implied as to the accuracy of this document. CMI assumes no liability for any injury, loss, damage, direct or consequential arising from the use of our products. User assumes all risk whatsoever in connection with its intended use. CMI also reserves the right to change this document without notice. 05/30/2018



CORRY MICRONICS, INC

# PRODUCT SPECIFICATION

## 8.0-12.0GHz Magnetically Shielded Microstrip Circulator Isolator Module

MODEL	FREQ (GHz)	BAND WIDTH	INSERTION LOSS (dB)		ISOLATION (dB)				VSWR	POWER (W) For. /Rev	OPERATING TEMP RANGE (°C)	WEIGHT (g)
			2-1	1-3	1-2	2-3	3-1	3-2				
CMISM8393B	8.3-9.3	FULL	0.5	0.9	20	20	30	20	1.25	15/3	-55-+85	1.0
CMISM9096B	9.0-9.6	FULL	0.5	0.9	20	20	30	20	1.25	15/3	-55-+85	1.0
CMISM95105B	9.5-10.5	FULL	0.5	0.9	20	20	30	20	1.25	15/3	-55-+85	1.0
CMISM100110B	10.0-11.0	FULL	0.5	0.9	20	20	30	20	1.25	15/3	-55-+85	1.0
CMISM110120B	11.0-12.0	FULL	0.5	0.9	20	20	30	20	1.25	15/3	-55-+85	1.0
CMISM80120B	8.0-12.0	FULL	0.7	1.2	14	14	26	14	1.35	15/3	-55-+85	1.0

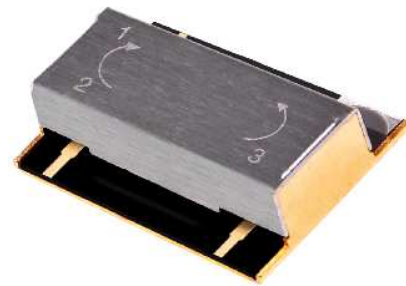
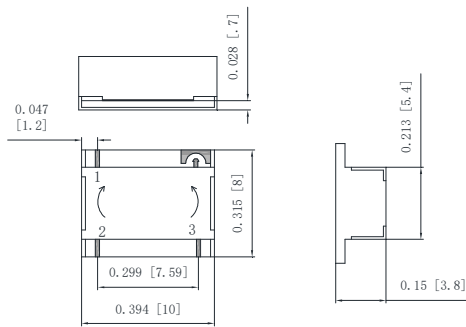
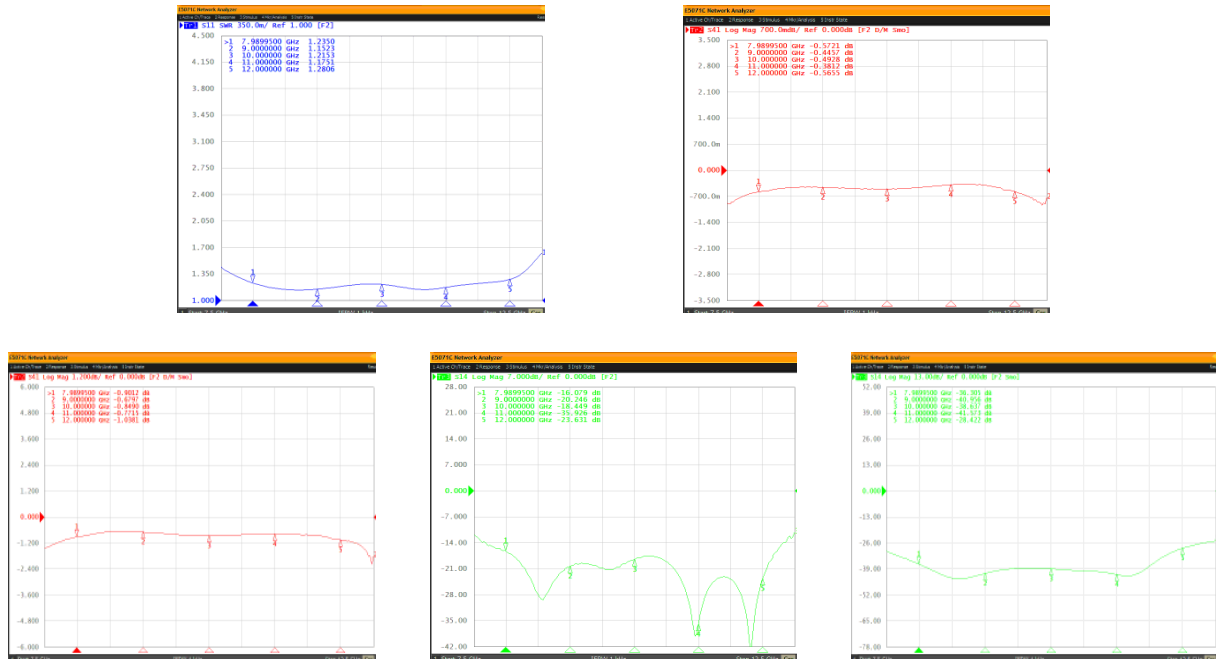

Figure 4-1-2



**CALL OUR SALES DEPARTMENT FOR MORE INFORMATION OR VARIATIONS OF THIS PRODUCT.**

**Corry Micronics, Inc. One Plastics Rd. - Corry, PA 16407**  
**(724) 940-7556 ext. 138 Fax (724) 940-7707 [www.cormic.com](http://www.cormic.com)**

Corry Micronics Inc. herein referred to CMI, believes this information to be accurate, but makes no warranties, expressed or implied as to the accuracy of this document. CMI assumes no liability for any injury, loss, damage, direct or consequential arising from the use of our products. User assumes all risk whatsoever in connection with its intended use. CMI also reserves the right to change this document without notice. 05/30/2018



CORRY MICRONICS, INC

# PRODUCT SPECIFICATION

## 14.0-18.0GHz Magnetically Shielded Microstrip Circulator Isolator Module

MODEL	FREQ (GHz)	BAND WIDTH	INSERTION LOSS (dB)		ISOLATION (dB)				VSWR	POWER (W) For. /Rev	OPERATING TEMP RANGE (°C)	WEIGHT (g)
			2-1	1-3	1-2	2-3	3-1	3-2				
CMISM140150A	14.0-15.0	FULL	0.5	0.9	20	20	30	20	1.25	12/3	-55-+85	0.6
CMISM150160A	15.0-16.0	FULL	0.5	0.9	20	20	30	20	1.25	12/3	-55-+85	0.6
CMISM155165A	15.5-16.5	FULL	0.5	0.9	20	20	30	20	1.25	12/3	-55-+85	0.6
CMISM160175A	16.0-17.5	FULL	0.5	0.9	20	20	30	20	1.25	12/3	-55-+85	0.6
CMISM145180A	15.0-18.0	FULL	0.6	1.0	18	18	30	18	1.30	12/3	-55-+85	0.6
CMISM140150A	14.0-18.0	FULL	0.7	1.1	16	16	28	16	1.35	12/3	-55-+85	0.6

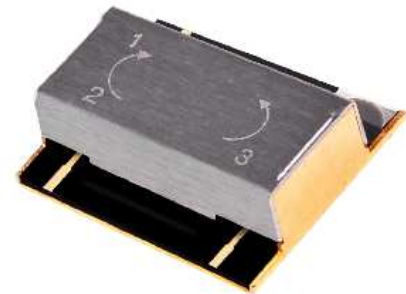
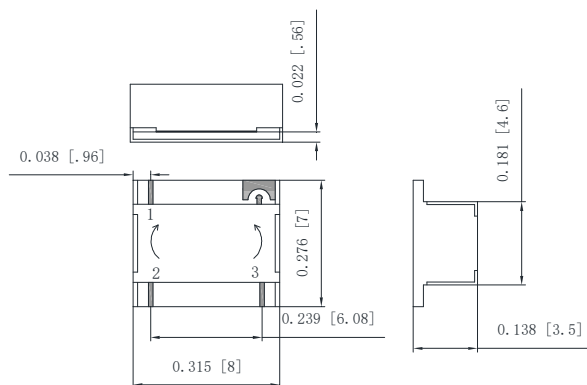

Figure 4-1-3



**CALL OUR SALES DEPARTMENT FOR MORE INFORMATION OR VARIATIONS OF THIS PRODUCT.**

**Corry Micronics, Inc. One Plastics Rd. - Corry, PA 16407**  
**(724) 940-7556 ext. 138 Fax (724) 940-7707 [www.cormic.com](http://www.cormic.com)**

Corry Micronics Inc. herein referred to CMI, believes this information to be accurate, but makes no warranties, expressed or implied as to the accuracy of this document. CMI assumes no liability for any injury, loss, damage, direct or consequential arising from the use of our products. User assumes all risk whatsoever in connection with its intended use. CMI also reserves the right to change this document without notice. 05/30/2018



CORRY MICRONICS, INC

# PRODUCT SPECIFICATION

## 14.0-18.0GHz Magnetically Shielded Microstrip Circulator Isolator Module

MODEL	FREQ (GHz)	BAND WIDTH	INSERTION LOSS (dB)		ISOLATION (dB)				VSWR	POWER (W) For. /Rev	OPERATING TEMP RANGE (°C)	WEIGHT (g)
			2-1	1-3	1-2	2-3	3-1	3-2				
CMISM140150B	14.0-15.0	FULL	0.5	0.9	20	20	30	20	1.25	12/3	-55-+85	0.6
CMISM150160B	15.0-16.0	FULL	0.5	0.9	20	20	30	20	1.25	12/3	-55-+85	0.6
CMISM155165B	15.5-16.5	FULL	0.5	0.9	20	20	30	20	1.25	12/3	-55-+85	0.6
CMISM160175B	16.0-17.5	FULL	0.5	0.9	20	20	30	20	1.25	12/3	-55-+85	0.6
CMISM145180B	15.0-18.0	FULL	0.6	1.0	18	18	30	18	1.30	12/3	-55-+85	0.6
CMISM140150B	14.0-18.0	FULL	0.7	1.1	16	16	28	16	1.35	12/3	-55-+85	0.6

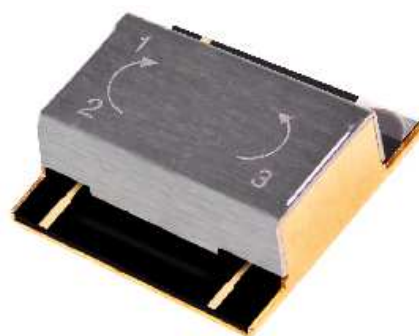
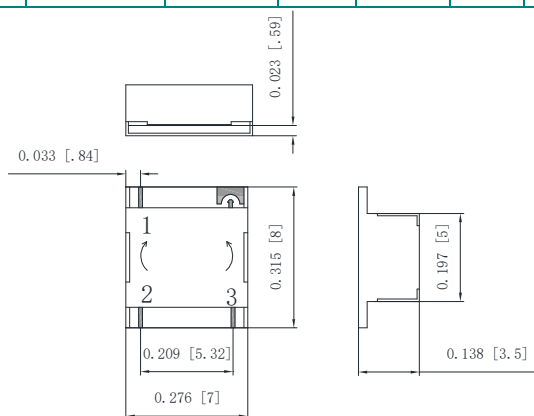
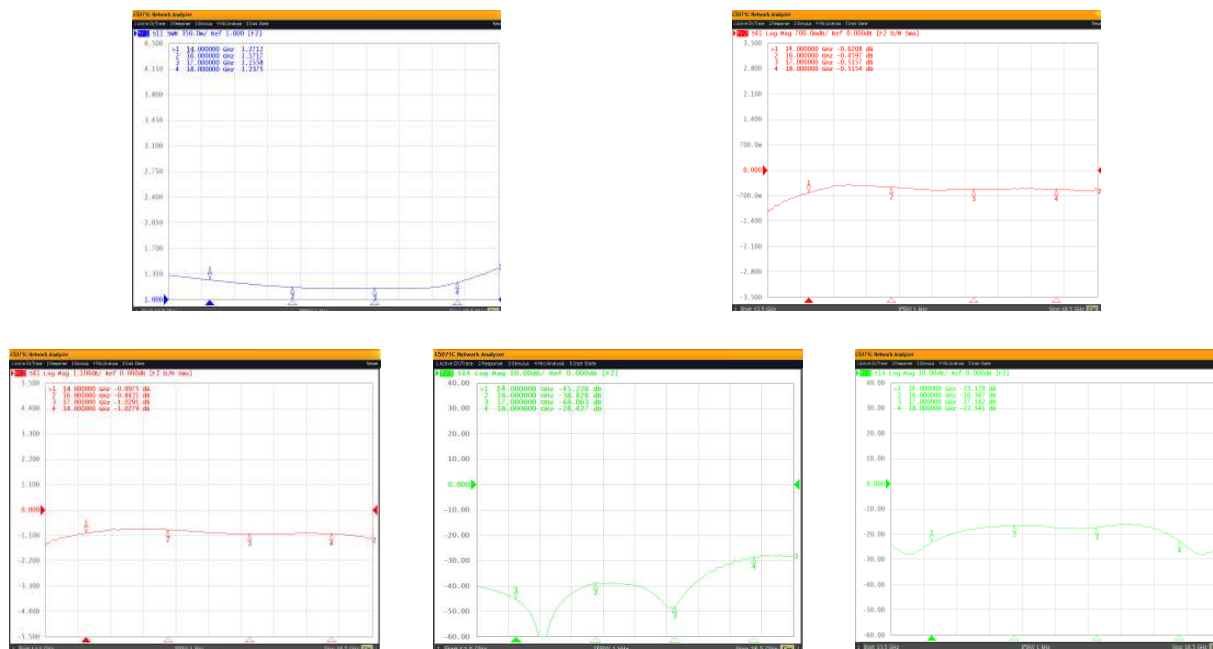

Figure 4-1-4



**CALL OUR SALES DEPARTMENT FOR MORE INFORMATION OR VARIATIONS OF THIS PRODUCT.**

**Corry Micronics, Inc. One Plastics Rd. - Corry, PA 16407**  
**(724) 940-7556 ext. 138 Fax (724) 940-7707 [www.cormic.com](http://www.cormic.com)**

Corry Micronics Inc. herein referred to CMI, believes this information to be accurate, but makes no warranties, expressed or implied as to the accuracy of this document. CMI assumes no liability for any injury, loss, damage, direct or consequential arising from the use of our products. User assumes all risk whatsoever in connection with its intended use. CMI also reserves the right to change this document without notice. 05/30/2018



CORRY MICRONICS, INC

# PRODUCT SPECIFICATION

## 8.0-12.0GHz Magnetically Shielded Microstrip Circulator Isolator Module

MODEL	FREQ (GHz)	BAND WIDTH	INSERTION LOSS (dB)		ISOLATION (dB)				VSWR	POWER (W) For. /Rev	OPERATING TEMP RANGE (°C)	WEIGHT (g)
			2-1	1-3	1-2	2-3	3-1	3-2				
CMISM8393C	8.3-9.3	FULL	0.5	0.9	20	20	30	20	1.25	15/3	-55-+85	1.0
CMISM9096C	9.0-9.6	FULL	0.5	0.9	20	20	30	20	1.25	15/3	-55-+85	1.0
CMISM95105C	9.5-10.5	FULL	0.5	0.9	20	20	30	20	1.25	15/3	-55-+85	1.0
CMISM100110C	10.0-11.0	FULL	0.5	0.9	20	20	30	20	1.25	15/3	-55-+85	1.0
CMISM110120C	11.0-12.0	FULL	0.5	0.9	20	20	30	20	1.25	15/3	-55-+85	1.0
CMISM80120C	8.0-12.0	FULL	0.7	1.2	14	14	26	14	1.35	15/3	-55-+85	1.0

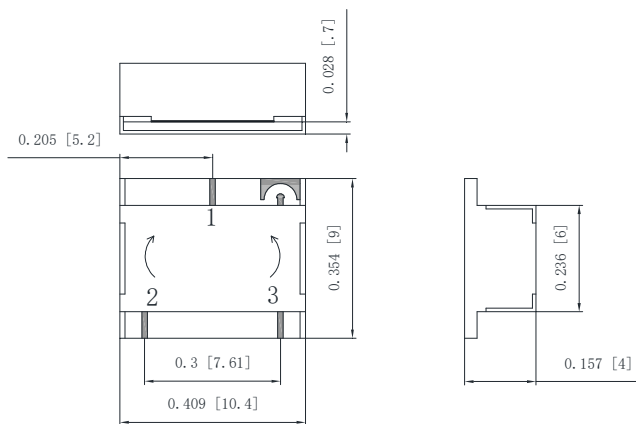
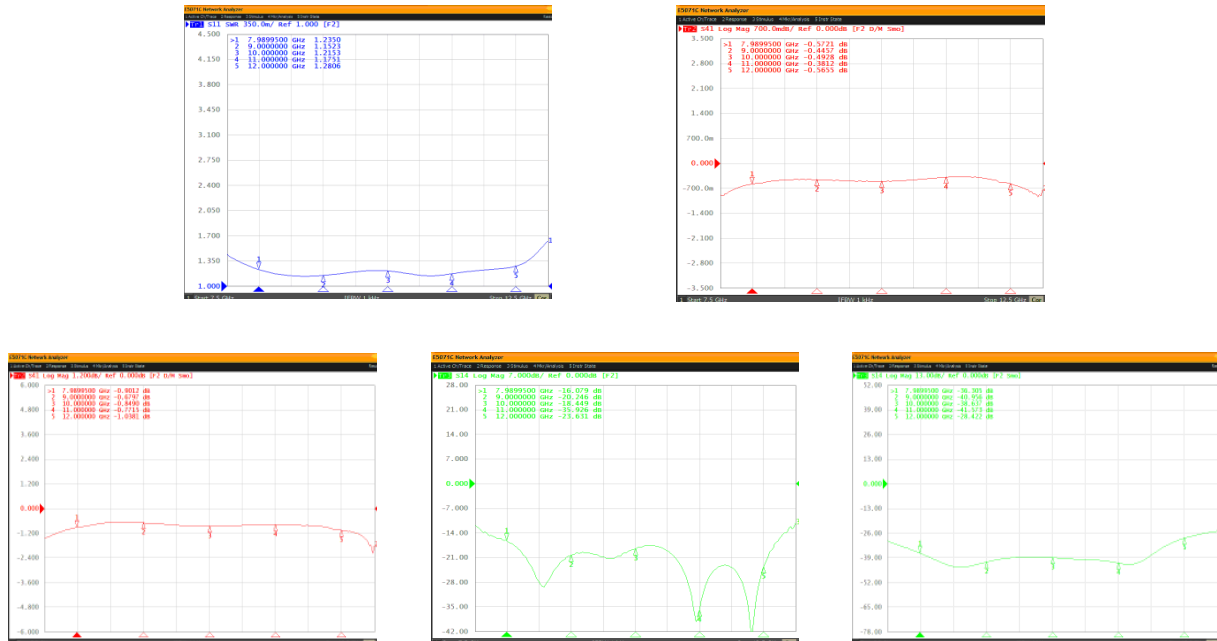

Figure 4-2-1



**CALL OUR SALES DEPARTMENT FOR MORE INFORMATION OR VARIATIONS OF THIS PRODUCT.**

**Corry Micronics, Inc. One Plastics Rd. - Corry, PA 16407**  
**(724) 940-7556 ext. 138 Fax (724) 940-7707 [www.cormic.com](http://www.cormic.com)**

Corry Micronics Inc. herein referred to CMI, believes this information to be accurate, but makes no warranties, expressed or implied as to the accuracy of this document. CMI assumes no liability for any injury, loss, damage, direct or consequential arising from the use of our products. User assumes all risk whatsoever in connection with its intended use. CMI also reserves the right to change this document without notice. 05/30/2018





CORRY MICRONICS, INC

# PRODUCT SPECIFICATION

## 14.0-18.0GHz Magnetically Shielded Microstrip Circulator Isolator Module

MODEL	FREQ (GHz)	BAND WIDTH	INSERTION LOSS (dB)		ISOLATION (dB)				VSWR	POWER (W) For. /Rev	OPERATING TEMP RANGE (°C)	WEIGHT (g)
			2-1	1-3	1-2	2-3	3-1	3-2				
CMISM140150C	14.0-15.0	FULL	0.5	0.9	20	20	30	20	1.25	12/3	-55-+85	0.6
CMISM150160C	15.0-16.0	FULL	0.5	0.9	20	20	30	20	1.25	12/3	-55-+85	0.6
CMISM155165C	15.5-16.5	FULL	0.5	0.9	20	20	30	20	1.25	12/3	-55-+85	0.6
CMISM160175C	16.0-17.5	FULL	0.5	0.9	20	20	30	20	1.25	12/3	-55-+85	0.6
CMISM145180C	15.0-18.0	FULL	0.6	1.0	18	18	30	18	1.30	12/3	-55-+85	0.6
CMISM140150C	14.0-18.0	FULL	0.7	1.1	16	16	28	16	1.35	12/3	-55-+85	0.6

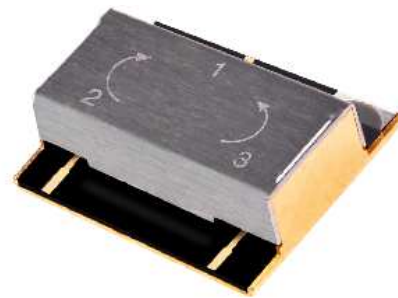
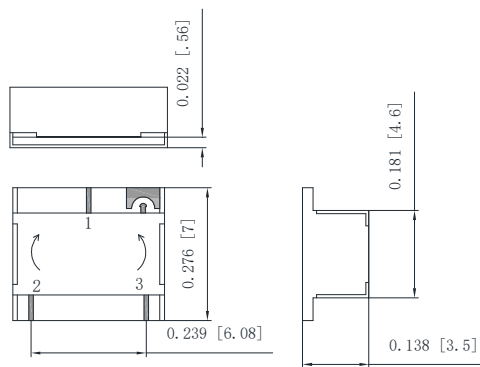
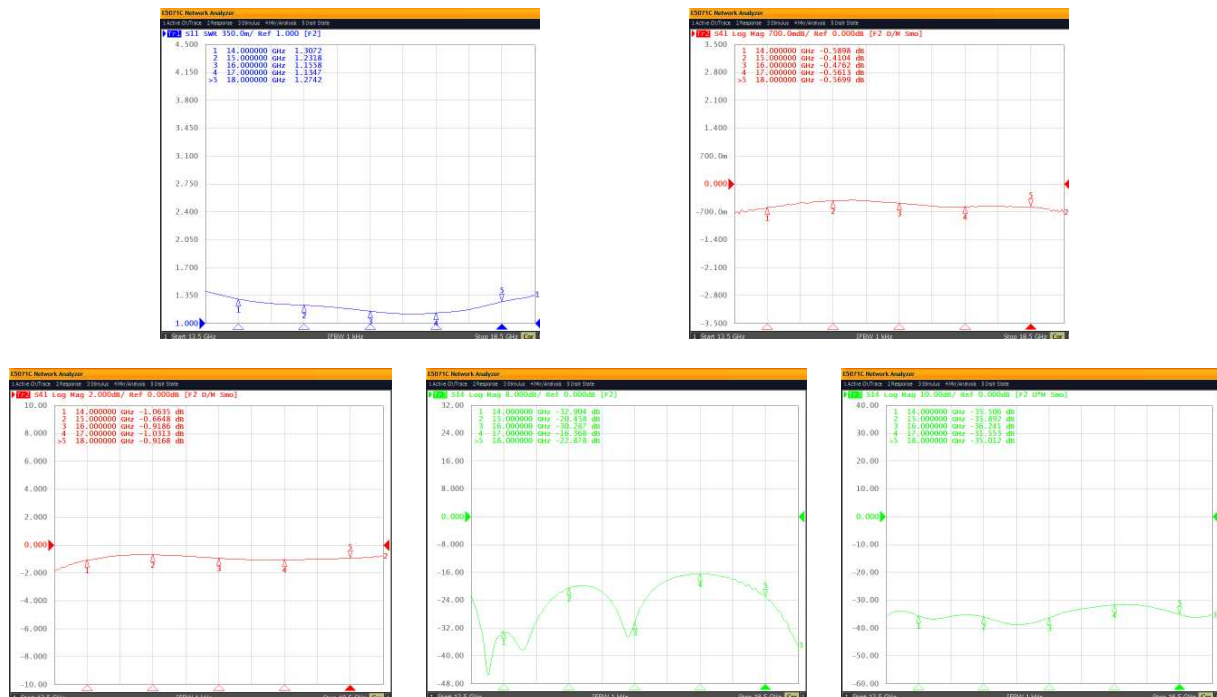

Figure 4-2-2



**CALL OUR SALES DEPARTMENT FOR MORE INFORMATION OR VARIATIONS OF THIS PRODUCT.**

**Corry Micronics, Inc. One Plastics Rd. - Corry, PA 16407**  
**(724) 940-7556 ext. 138 Fax (724) 940-7707 [www.cormic.com](http://www.cormic.com)**

Corry Micronics Inc. herein referred to CMI, believes this information to be accurate, but makes no warranties, expressed or implied as to the accuracy of this document. CMI assumes no liability for any injury, loss, damage, direct or consequential arising from the use of our products. User assumes all risk whatsoever in connection with its intended use. CMI also reserves the right to change this document without notice. 05/30/2018



CORRY MICRONICS, INC

# PRODUCT SPECIFICATION

## 14.0-18.0GHz Magnetically Shielded Microstrip Circulator Isolator Module

MODEL	FREQ (GHz)	BAND WIDTH	INSERTION LOSS (dB)		ISOLATION (dB)				VSWR	POWER (W) For. /Rev	OPERATING TEMP RANGE (°C)	WEIGHT (g)
			2-1	1-3	1-2	2-3	3-1	3-2				
CMISM140150D	14.0-15.0	FULL	0.5	0.9	20	20	30	20	1.25	12/3	-55-+85	0.6
CMISM150160D	15.0-16.0	FULL	0.5	0.9	20	20	30	20	1.25	12/3	-55-+85	0.6
CMISM155165D	15.5-16.5	FULL	0.5	0.9	20	20	30	20	1.25	12/3	-55-+85	0.6
CMISM160175D	16.0-17.5	FULL	0.5	0.9	20	20	30	20	1.25	12/3	-55-+85	0.6
CMISM145180D	15.0-18.0	FULL	0.6	1.0	18	18	30	18	1.30	12/3	-55-+85	0.6
CMISM140150D	14.0-18.0	FULL	0.7	1.1	16	16	28	16	1.35	12/3	-55-+85	0.6

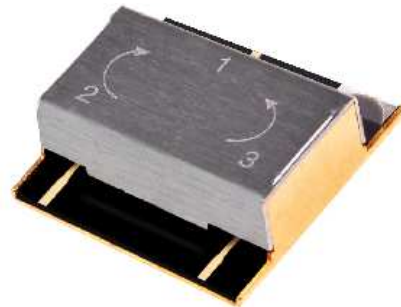
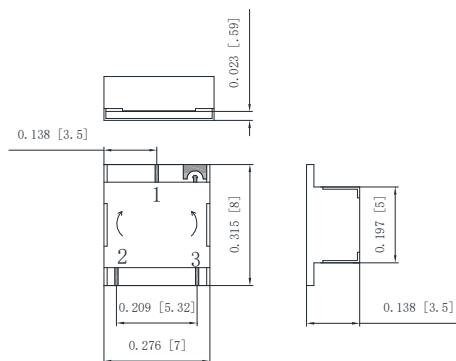
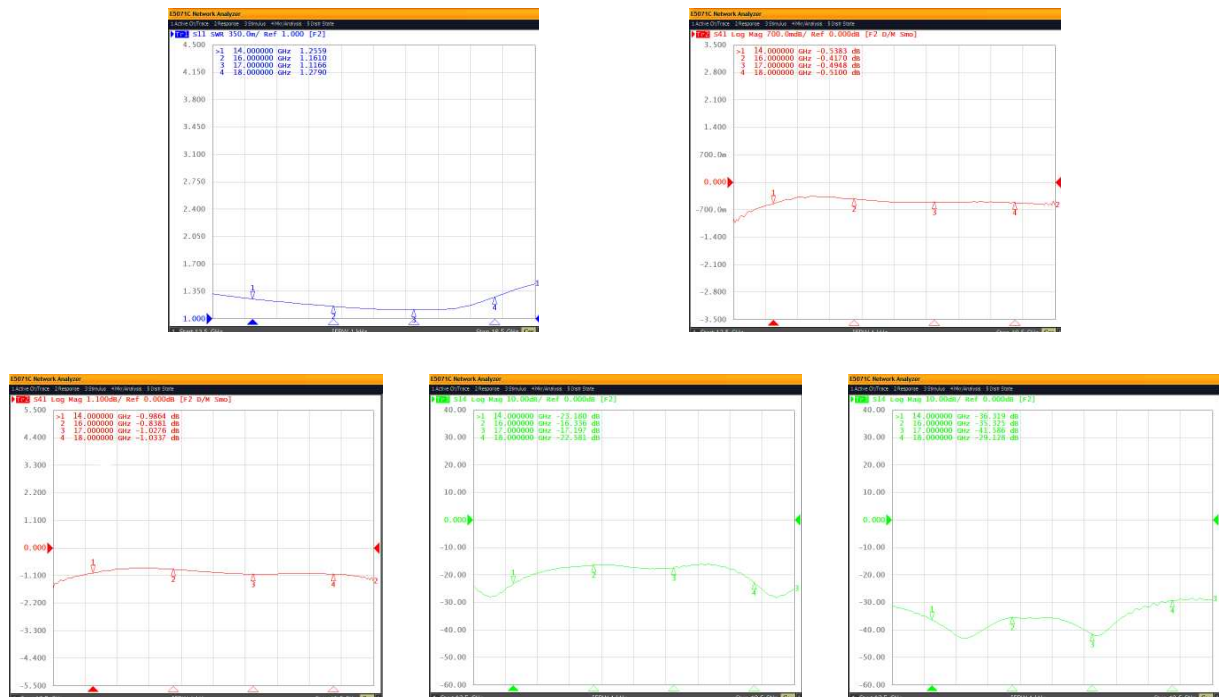

Figure 4-2-3



**CALL OUR SALES DEPARTMENT FOR MORE INFORMATION OR VARIATIONS OF THIS PRODUCT.**

**Corry Micronics, Inc. One Plastics Rd. - Corry, PA 16407**  
**(724) 940-7556 ext. 138 Fax (724) 940-7707 [www.cormic.com](http://www.cormic.com)**

Corry Micronics Inc. herein referred to CMI, believes this information to be accurate, but makes no warranties, expressed or implied as to the accuracy of this document. CMI assumes no liability for any injury, loss, damage, direct or consequential arising from the use of our products. User assumes all risk whatsoever in connection with its intended use. CMI also reserves the right to change this document without notice. 05/30/2018



CORRY MICRONICS, INC

# PRODUCT SPECIFICATION

## 15.0 GHz -17.0GHz Dual Channel Circulator & Isolator Module

MODEL	FREQ (GHz)	BAND WIDTH	INSERTION LOSS (dB)	ISOLATION (dB)	VSWR	POWER (W) For. /Rev	OPERATING TEMP RANGE (°C)
CMIDCM150170A	15-17	FULL	0.5、0.9	18、30	1.25	15/3	-55~+85

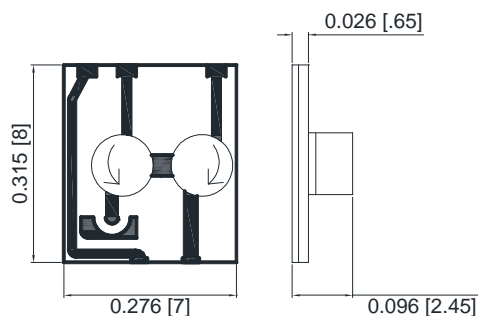

Figure 6-1

## 15.0 GHz -17.0GHz Dual Channel Circulator Module

MODEL	FREQ (GHz)	BAND WIDTH	INSERTION LOSS (dB)	ISOLATION (dB)	VSWR	POWER (W) For. /Rev	OPERATING TEMP RANGE (°C)
CMIDCM150170B	15-17	FULL	0.5	20	1.25	15	-55~+85

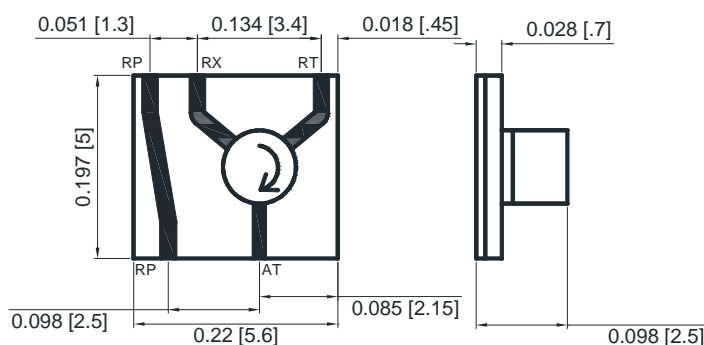

Figure 6-2

**CALL OUR SALES DEPARTMENT FOR MORE INFORMATION OR VARIATIONS OF THIS PRODUCT.**

**Corry Micronics, Inc.** One Plastics Rd. - Corry, PA 16407  
 (724) 940-7556 ext. 138 Fax (724) 940-7707 [www.cormic.com](http://www.cormic.com)

Corry Micronics Inc. herein referred to CMI, believes this information to be accurate, but makes no warranties, expressed or implied as to the accuracy of this document. CMI assumes no liability for any injury, loss, damage, direct or consequential arising from the use of our products. User assumes all risk whatsoever in connection with its intended use. CMI also reserves the right to change this document without notice. 05/30/2018



CORRY MICRONICS, INC

# PRODUCT SPECIFICATION

15.0GHz -17.0GHz Magnetically Shielded Dual Channel Circulator Module

MODEL	FREQ (GHz)	BAND WIDTH	INSERTION LOSS (dB)	ISOLATION (dB)	VSWR	POWER (W) For. /Rev	OPERATING TEMP RANGE (°C)
CMIDCM150170C	15-17	FULL	0.5	20	1.25	15/3	-55~+85

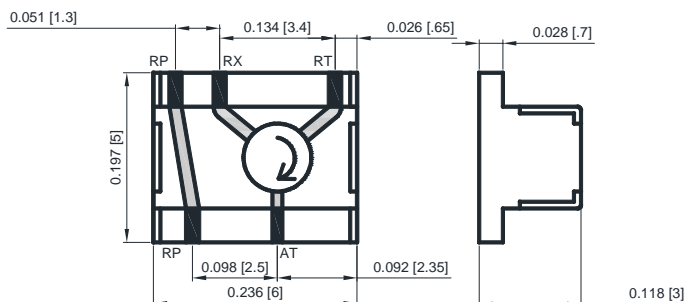

Figure 7-1

15.0GHz -17.0GHz Magnetically Shielded Dual Channel Circulator & Isolator Module

MODEL	FREQ (GHz)	BAND WIDTH	INSERTION LOSS (dB)	ISOLATION (dB)	VSWR	POWER (W) For. /Rev	OPERATING TEMP RANGE (°C)
CMIDCM150170D	15-17	FULL	0.6,1.0	16、30	1.30	15/3	-55~+85

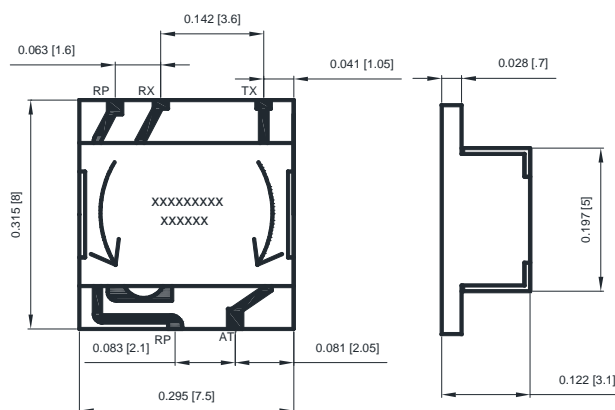

Figure 7-2

**CALL OUR SALES DEPARTMENT FOR MORE INFORMATION OR VARIATIONS OF THIS PRODUCT.**

**Corry Micronics, Inc.** One Plastics Rd. - Corry, PA 16407  
 (724) 940-7556 ext. 138 Fax (724) 940-7707 [www.cormic.com](http://www.cormic.com)

Corry Micronics Inc. herein referred to CMI, believes this information to be accurate, but makes no warranties, expressed or implied as to the accuracy of this document. CMI assumes no liability for any injury, loss, damage, direct or consequential arising from the use of our products. User assumes all risk whatsoever in connection with its intended use. CMI also reserves the right to change this document without notice. 05/30/2018



CORRY MICRONICS, INC

# PRODUCT SPECIFICATION

## Application Notes

**Storage:** Store in dry environment (Nitrogen cupboard or drying cupboard).

**Handling:** In clean environment, manipulate product with dust-free tweezers to avoid damaging the base-plate or scratching the microstrip circuit.

**Cleaning:** This product can be cleaned in absolute ethanol or scrub the surface with absolute ethanol soaked cotton ball. Do NOT clean it with ultrasonic wave.

### Body Installation Methods:

- 1) Soldering (only recommended for parts up to 5GHz): Recommend using  $<183^{\circ}\text{C}$  solder such as Sn63Pb37 soldering paste. Do not leave on hotplate over  $210^{\circ}\text{C}$  for over 30 seconds.
- 2) Conductive epoxy: Spread small amount of conducting adhesive gel uniformly on the installation site. Curing time less than 2 hours ( $150^{\circ}\text{C}$ ).

### Pin connection:

- 1) Soldering: Put the unit on the  $120^{\circ}\text{C}$  hot plate to heat it. Then lap the gold plating arc copper foil connection line to microstrip line with flux. Recommend using  $183^{\circ}\text{C}$  Sn63Pb37 to solder. Soldering time not over 2 seconds.
- 2) Wire bonding: Recommend using  $25\mu\text{m}$  gold wire with bonding temp  $100\text{-}150^{\circ}\text{C}$  with sphere bonding pressure 30-55gf and carve bonding pressure 15-25gf.

**Assembly gap:** Should short the product and ceramic wafer gap. Typical value: 0.002-0.006 inches

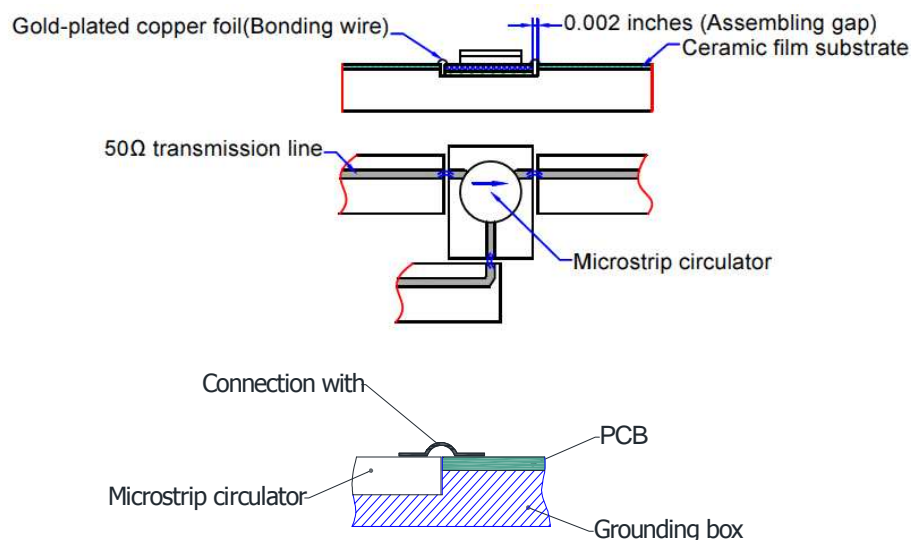

**CALL OUR SALES DEPARTMENT FOR MORE INFORMATION OR VARIATIONS OF THIS PRODUCT.**

**Corry Micronics, Inc. One Plastics Rd. - Corry, PA 16407**  
**(724) 940-7556 ext. 138 Fax (724) 940-7707 [www.cormic.com](http://www.cormic.com)**

Corry Micronics Inc. herein referred to CMI, believes this information to be accurate, but makes no warranties, expressed or implied as to the accuracy of this document. CMI assumes no liability for any injury, loss, damage, direct or consequential arising from the use of our products. User assumes all risk whatsoever in connection with its intended use. CMI also reserves the right to change this document without notice. 05/30/2018