

RF FILTER SPECIFICATION

Part No. BP34R1880S60A

Item	Parameter	General Specification
1	Center Frequency(f_o)	1880 MHz
2	Bandwidth (BW)	$f_o \pm 30$ MHz
3	Insertion loss in BW	2.5 dB max.
4	Ripple in BW	1.0 dB max.
5	V S W R in BW	1.8 : 1
6	Stop Band Rejection (Absolute Value)	18 dB min. at ($f_o \pm 100$ MHz)
7	Nominal Characteristic impedance	50 Ω

TOP VIEW

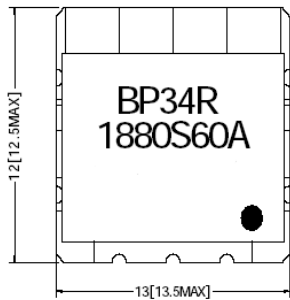

TOLERANCE : .X : ± 0.3
 : .XX : ± 0.15

UNIT: mm

● INPUT PORT

BOTTOM VIEW

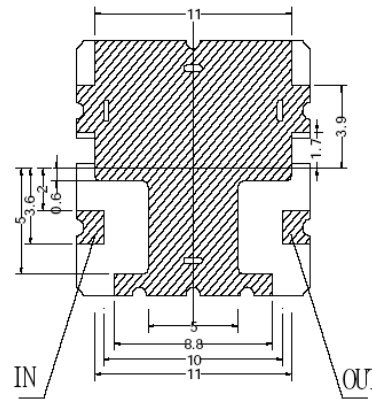

CALL OUR SALES DEPARTMENT FOR MORE INFORMATION OR VARIATIONS OF THIS PRODUCT.

Corry Micronics, Inc. One Plastics Rd. - Corry, PA 16407
(814) 664-7728 Fax (814) 664-4582 www.cormic.com

Corry Micronics Inc. herein referred to CMI, believes this information to be accurate, but makes no warranties, expressed or implied as to the accuracy of this document. CMI assumes no liability for any injury, loss, damage, direct or consequential arising from the use of our products. User assumes all risk whatsoever in connection with it's intended use. CMI also reserves the right to change this document without notice.