

RF FILTER SPECIFICATION

Part No. BP34R947S25A

Electrical Specifications			
Item	Parameter	CMI Specification	Unit
1	Center Frequency	947.5	MHz
2	Pass band (BW)	$f_0 \pm 12.5$	MHz
3	Insertion loss in BW	5.6 max.	dB
4	Ripple in BW	2.6 max.	dB
5	VSWR in BW	2.0 max.	-
6	Input power	50	Ω
7	Attenuation □ Absolute Value	30 min. in 890 - 915 MHz	dB
		20 min. in D > 925 MHz	dB
		10 min. at 970 MHz	dB

TOP VIEW

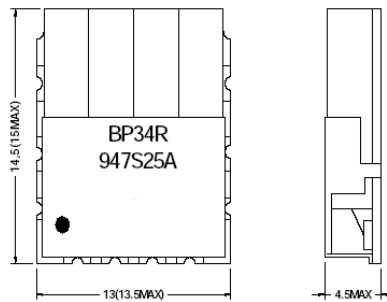

BOTTOM VIEW

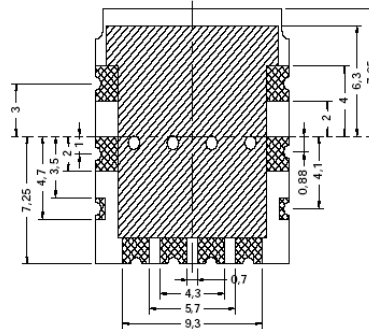

TOLERANCE: .X : ± 0.3
 .XX : ± 0.15

UNIT: mm
 ● : IN

▨ : SOLDER MASK
 ▩ : GOLD PLATING

CALL OUR SALES DEPARTMENT FOR MORE INFORMATION OR VARIATIONS OF THIS PRODUCT.

Corry Micronics, Inc. One Plastics Rd. - Corry, PA 16407
(814) 664-7728 Fax (814) 664-4582 www.cormic.com

Corry Micronics Inc. herein referred to CMI, believes this information to be accurate, but makes no warranties, expressed or implied as to the accuracy of this document. CMI assumes no liability for any injury, loss, damage, direct or consequential arising from the use of our products. User assumes all risk whatsoever in connection with it's intended use. CMI also reserves the right to change this document without notice.